

Have You Found The Right Dollhouse Yet?

All It Takes Is BEGINNER'S LUCK™

Beginner's Luck* is a Victorian Gingerbread House.

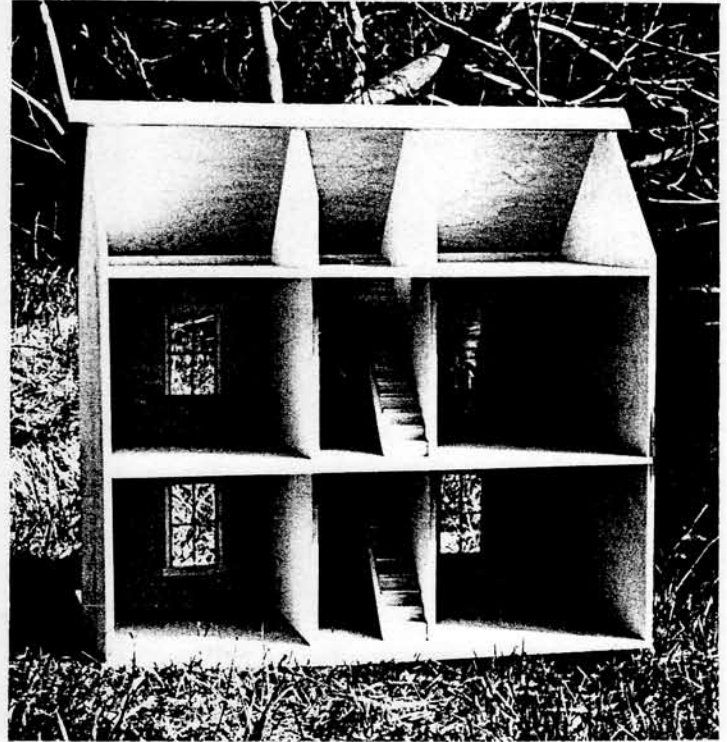
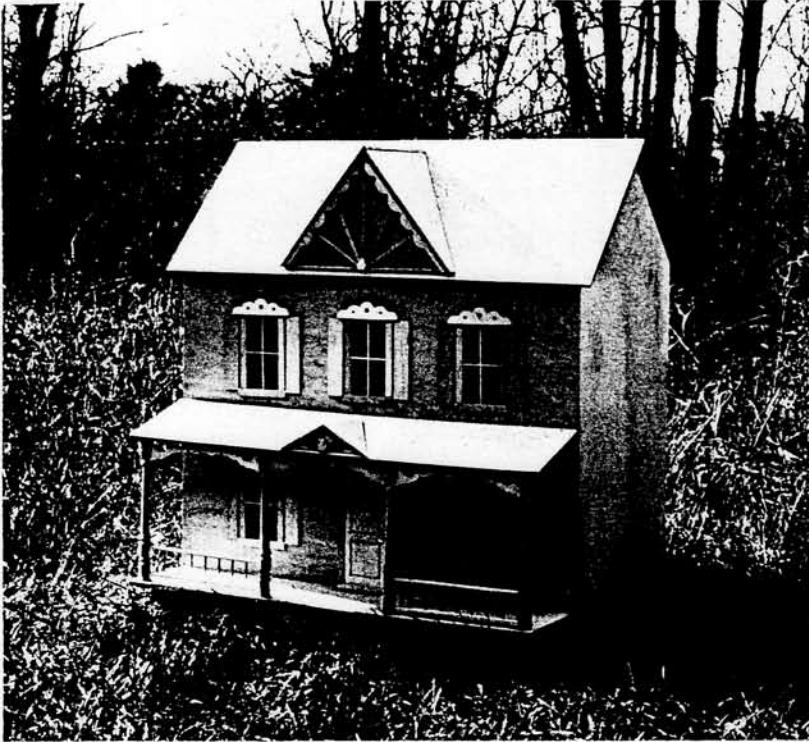

1 Beginner's Luck* is Complete with Plexiglass windows, wooden mullions, inside and outside window and door trim, a panelled door with brass hinges and knob, and shutters.

2 Beginner's Luck* is easy to assemble. Slotted and

grooved construction—created especially for this house by Real Good Toys*—makes assembly a cinch.

3 Beginner's Luck* (28" LX 28" WX 21" D) has 9 big rooms and 2 staircases. Window and door openings are cut to accommodate standard-sized components.

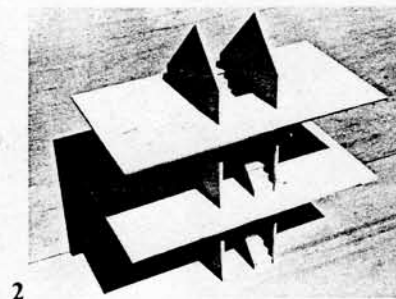
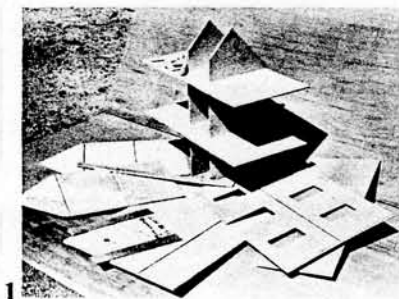

- Easy assembly
- All openings accept standard components
- Precision pre-cut parts
- All wood construction
- Built to last
- Handmade by Vermont Craftspeople

CALL: (802) 479-2217

Real Good Toys • 10 Quarry Hill • Barre, VT 05641

BEGINNER'S LUCK FARMHOUSE/VICTORIAN PORCH

①

Parts list: 1 porch roof panel, 2 pine triangles, 1 angled pine strip 1 1/8" wide, 1 small angled pine strip, 4 porch columns (2 with 1 top notch, 2 with 2 top notches), 4 porch railings, 1/8" porch railing dowels, 1 porch gable triangle, 2 porch gable roof panels, 2 short & 2 long porch-gable trim, 1 center gable trim

Assemble railings first: put 1/8" dowels in one side of each railing (A) sink each dowel about 1/8" deeper than the railing (B) Then turn over, and, with tack hammer, tap dowels onto holes of other railings (C) Even up surfaces on both sides.

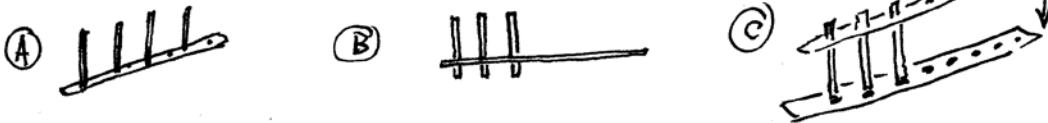

Next, attach porch columns to railings. Railings go in parallel slots on column. Before attaching: Test ends of railings to see if they fit easily into the slots. You may have to sand the ends a bit to assure fit. Each column assembly consists of 1 column with 1 top notch, 1 with 2 top notches. Make sure slots on each column face each other.

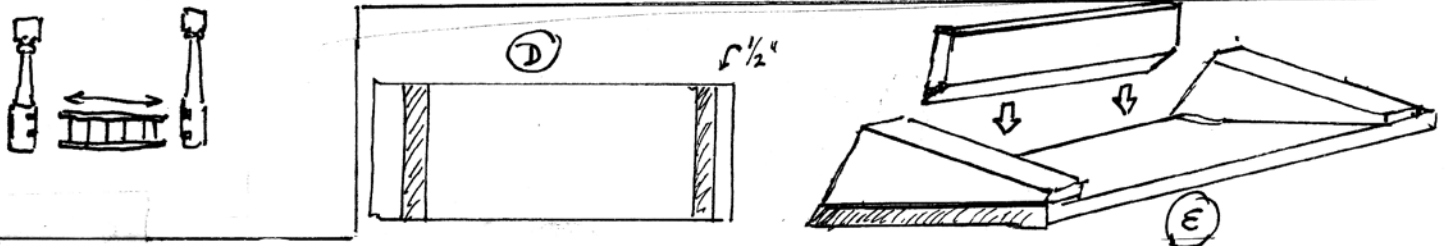

Put pine triangles on roof panel, making sure rear angle of panel is continuous (fig E) Then put angled pine strips between triangles. Again, rear angle must be continuous. Larger strip goes in back, smaller in front. Front strip should look like a continuation of the triangles. Even the ends- triangles will each be approx. 1/2" from the ends of the roof panel. When you're sure of how it will go, mark it on the roof, and glue the pieces on. You may want to clamp the pieces, nail them (FROM THE TOP) or simply put something heavy on them to keep them flat.

When this is dry, turn the roof over so top is up. (F)

Assembling the porch gable: Lay roof panels (of gable) top down, with grooves up and roof lines parallel (G) Put glue in each groove and on the roof-line edges. Attach to gable triangle with front facing out (That means the angle on the triangle bottom edge will be sloping with the slant of the roof). (H) You may want to use a rubber band to clamp it.

Then attach the trim to the face of the triangle: Glue on smaller pieces first (J) then glue on larger pieces (K) Then glue the center trim piece of gable over the others (L)

When dry, glue the entire unit onto the porch roof, with the front edge of the gable roof panels at the front edge of the porch roof. (M)

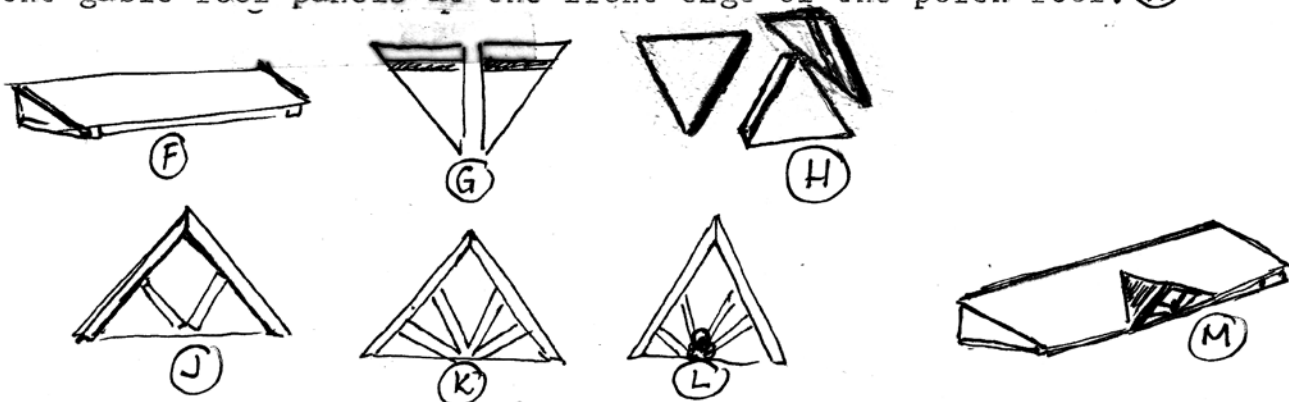

Next: the most difficult part of the assembly-use patience!

Also, use rubber cement..to make sure things work the way you plan them. With rubber cement you can have a "dry run" and increase your understanding to make the final assembly go right.

Turn the roof over, so it's bottom up. Since you've added the gable, it will sit level.

Attach the column assembly to the roof (using rubber cement). The outside column (the one with only 1 top groove) on the triangle, the inside column on the front strip. Try to get them as straight as possible. (N)

Now repeat on the other side, and turn the porch assembly over.

The triangles and rear strip will be glued flush to the front of the house, at the height of the columns.(P) If the columns sit flush to the base of the house when the rear strip and triangles are also flush, go ahead and re-glue- you've got it right! If not, either try again or try it this way: Glue the (rubber cement) columns down first, onto the base, after marking their proper place. Then attach the roof assembly to the porch column assemblies.

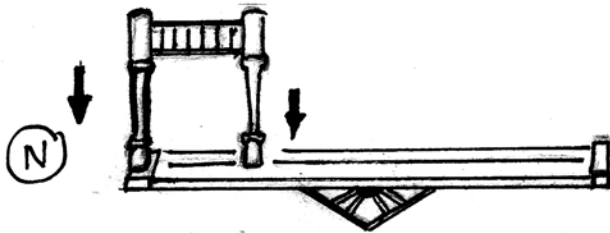

TOP VIEW OF PORCH COLUMNS - ARRANGEMENT OF TOP NOTCHES

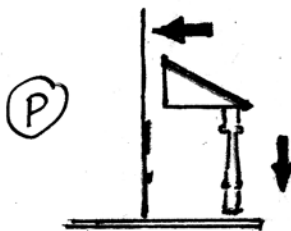

DON'T FORGET THAT YOU CAN ADD VICTORIAN GINGERBREAD TO YOUR HOUSE TO MAKE IT EXTRA SPECIAL!! IF YOU DON'T ALREADY HAVE IT, ASK YOUR DEALER .

WE HOPE YOU LOVE YOUR HOUSE! - FROM YOUR FRIENDS AT



REAL GOOD TOYS